

480 Motor Yacht

2002



FEATURES

- LARGE, ONE-LEVEL HELM & DECK AREA.
- LARGE MASTER STATEROOM WITH TWO HANGING LOCKERS AND DRAWER STORAGE.
- LARGE STORAGE AREA WITH WASHER/DRYER, ACCESSED FROM GALLEY STEPS.
- LARGE SALON WINDOWS.
- COCKPIT AIR CONDITIONING.

SEA RAY SPORT YACHTS 2002

480 MOTOR YACHT

OVERALL LENGTH

W/STD. SWIM PLATFORM	50' 5"	15.24 M
BEAM	15' 3"	4.65 M
DRAFT (INBOARDS)	47"	119.4 CM
DRY WEIGHT	38,500 LBS	17,464 KG
FUEL CAPACITY	500 GAL	1,892.5 L
WATER CAPACITY	120 GAL	454.2 L
HOLDING TANK	60 GAL	227.1 L
DEAD RISE	15°	15°

Sea Ray

480 Motor Yacht

2002

Features and Standard Equipment

HULL & DECK FEATURES

Bottom Paint
Bow Rail, 316 Stainless Steel w/Safety Line & Port & Starboard Entryways
Cleats, Custom Sea Ray® Thru-Bolted - Stainless Steel (8)
Color Schemes (Blue, Green, Black/Gold)
Deck Fill Plates, Stainless Steel
Deck Rails, 316 Stainless Steel
Gel-Coat, Arctic White
Graphics, Striping
Portlights, Stainless Steel (6 Fixed, 4 Opening)
Resin, High-Performance Vinylster
Rub Rail, PVC w/Stainless Steel Insert
Storage, Transom Wall - Fenders & Gear
Stringer System, Fiberglass w/Sound Dampening
Swim Platform, Extended w/Concealed Stainless Steel Three-Step Swim Ladder
Thru-Hull Fittings, Color-Coordinated
Vent System, Engine Room - Integral
Window, Aft Stateroom (Kick-Out)
Windows, Tempered/Tinted Glass Bonded-In
Windshield, Aluminum Curved Tri-Section Tinted Glass
Electric Front Vent & Sliding Side Windows
Windshield Washer System w/Stainless Steel Nozzles
Windshield Wipers

Canvas (Sunbrella®):

Canvas Storage Bag
Hardtop Enclosure
Windshield Shades

Windlass System:

Anchor Chute, Stainless Steel
Anchor Rope/Chain Storage w/Hatch
Anchor Washdown Spigot
Windlass, Rope/Chain w/Foot Switches (Lofrans Progress II)

Meets Applicable USCG & ABYC Standards
NMMA Certification

COCKPIT FEATURES

Carpet Liner, Snap-In
Door, Cabin Entry - Acrylic
Door, Transom
Doors, Aft Deck Entry - Acrylic (Port & Starboard)
Floor Liner, Fiberglass - Self-Bailing
Handrails, 316 Stainless Steel
Hardtop, Fiberglass, 20x20 Hatch w/Skyscreen Cover, Overhead Lighting & Red Night Lighting
Lighting, 12V
Lighting, 12V w/4-Way Switching Capability
Lighting, Indirect
Outlet, 12V Accessory
Seating, Companion Bench
Seating, Helm - Custom w/Heavy-Duty Pedestal, Slide & Electric Vertical Adjustments
Ship's Bell
Skirting, Aft Deck - Molded Fiberglass Doors w/Storage
Stereo, 12V AM/FM Single CD w/6-Disc CD Changer, Amplifier, Subwoofer, Speakers (4) & Digital Remote Controls (Clarion®)
Storage, Aft
Storage, Port Cockpit Base
Wet Bar w/Sink, Trash Receptacle, Grab Handles, Stainless Steel Beverage Holders & Ice Maker (120V)

CABIN FEATURES

Carbon Monoxide Monitors
Carpet, Deep-Pile BCF - 44-Ounce
Carpet Runners, Interior (Sunbrella®)
Interior Finish - Hampton Cherry (also available in Hampton Maple)
Lighting, 12V Indirect
Outlets, 120V GFI Protected
Pillows, Accent
Polished Chrome Outlet & Switch Plates
Shades, Fabric Day/Night w/Drape Trim
Vacuum System, Central - Dual Inlet (Beam™)
Wood Trim, Handcrafted

Salon:

Entertainment Center
- Stereo, 12V Double Din AM/FM Digital Cassette & Single CD w/6-Disc CD Changer, Amplifier & Speakers (6)
- Storage, Cabinet - CD & Videotapes
- TV/VCR/Radio Combo, 20" w/Remote & Outlet for Antenna & TV Coax to Dockside
Hatch, Engine Service - Gas-Assisted
Ottomans (2) - Convert to Cocktail Table
Seating, Crescent-Shaped Sofa w/Ottoman (Ultraleather HP™) & Storage Below
Seating, Port Sofa w/Ottoman
Storage, Cabinets - Port
Table, Dining/Cocktail Hi-Lo

Dinette:

Seating, Opposing Dinette w/Storage Below
Table, Dinette (Folding Leaf) w/Corian® Surface

Galley:

Breakfast Bar
Coffeemaker, 120V (Spacemaker™)
Countertop, Molded Fiberglass w/Granite-Colored Gel-Coat, Sink, Single-Lever Grohe® Faucet & Corian® Sink Cover
Flooring, Wood
Handrails, Stainless Steel
Lighting, Dual-Voltage - 120V/12V
Microwave/Convection Oven, 120V
Power Vent, 12V
Refrigerator/Freezer, Dual-Voltage - 120V/12V
Storage, Upper & Lower w/Designated Plate & Glass Storage
Stove, 120V Recessed Three-Burner w/Corian® Cover
Trash Receptacle w/Chute & Corian® Cover
Washer/Dryer Combo, 120V in Step Storage Compartment

Aft Master Stateroom:

Bed, Queen-Size w/Innerspring Mattress, Pillows, Sheets, Coordinated Spread & Storage Below w/Gas-Assisted Actuators
Door, Privacy
Hanging Locker, Full-Length Cedar-Lined
Mirror, Full-Length
Nightstand, Built-In
Storage, Dresser Drawer Unit
TV/VCR/Radio Combo, 20" w/Remote & Outlet for Antenna & TV Coax to Dockside

Aft Master Stateroom Head/Shower:

Bath Accessories, Chrome
Clothes Hook
Door, Head - Private Access from Vanity Area
Door, Shower - Private Access from Vanity Area
Handrails, Elliptical Stainless Steel
Head (VacuFlush®)
Power Vent, 12V
Shower w/Seat, Adjustable Shower Wand
Storage, Cabinet - Upper
Storage, Medicine Cabinet - Mirrored
Vanity w/Molded Solid Surface Countertop w/Integral Sink, Grohe® Faucet & Drawer Storage

Forward Stateroom:

Bed, Full-Size w/Innerspring Mattress, Pillows, Sheets, Coordinated Spread & Drawer Storage Below
Door, Privacy - Sliding Pocket
Hanging Locker, Full-Length w/Lights & Mirrored Doors - Starboard
Mirrored Rope Locker Bulkhead
Storage, Cabinet w/Drawers - Port
Storage, In-Floor
Storage, Side Shelves
TV/VCR/Radio Combo, 13" w/Remote & Outlet for Antenna & TV Coax to Dockside

Forward Head/Shower:

Bath Accessories, Chrome
Clothes Hook
Door, Privacy - Access from Forward Stateroom
Door, Privacy - Access from Salon
Handrails, Elliptical Stainless Steel
Head w/Fiberglass Settee Lid (VacuFlush®)
Power Vent, 12V
Shower Grate, Teak - Removable
Shower w/Seat, Adjustable Shower Wand & Circular Acrylic Door
Storage, Medicine Cabinet - Mirrored
Vanity w/Solid Surface Countertop, Sink, Grohe® Faucet & Storage Below

Guest Stateroom:

Bed, Two Twin Beds w/Filler Cushions to Convert into King-Size Bed w/Pillow Cases & Sheets
Door, Privacy
Hanging Locker, Full-Length, Cedar-Lined w/Light & Mirrored Door

NOTE: Boats which are ordered with 220V/50 Cycle Electrical Systems will be installed with the appropriate appliances in the corresponding voltage.

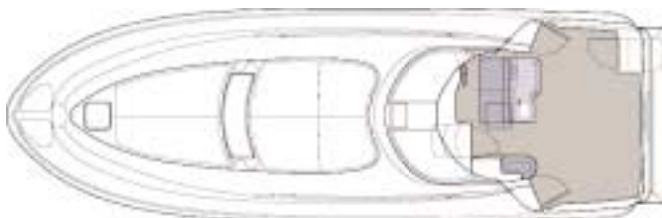

Cockpit Layout w/Standard Seating

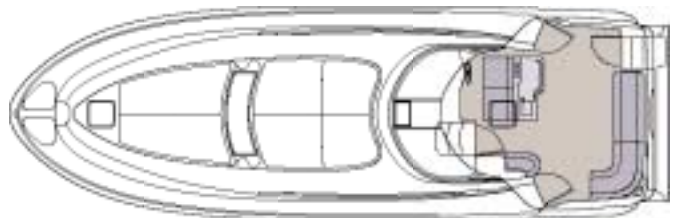

Cockpit Layout w/Optional Seating

TECHNICAL

Control Station:

Alarms, Engine - Oil, Water & Transmission Oil
Alarms, High-Water - Bilge
Bow Thruster
Compass
Emergency Engine Stop
Emergency Start System - Engines
Gel-Coated Dash - Tan
Horns, Air (Concealed) - Dual Trumpet
Instrumentation, Custom Sea Ray®
Backlit w/Low-Glare Blue Night Lighting &
Stainless Steel Bezels

Multigauge (4 in 1) (2)

- Fuel
- Oil Pressure (2)
- Tachometers w/LCD Hourmeters (2)
- Voltmeters
- Water Temperature

Panel, Instrument - High-Gloss Burl

Panel, Switch - Backlit High-Gloss Burl

Shift & Throttle Controls w/Gold Knobs

Spotlight w/Dual Halogen Bulbs - Remote-Controlled (ACR®)

Steering, Hydraulic

Steering, Tilt Wheel

Steering Wheel, Wood-Accent

Switches, Illuminated Weatherproof Rockers & Dimmer Control

Systems Monitor, Digital LCD - for Engine Diagnostics &

Pump Monitoring

Electronics:

GPS (Raymarine RayNav 300 GPS) w/WAAS Differential Sensor

Multifunction Instrument (Raymarine Tridata ST-60)

- Depth Finder
- Speed/Sumlog
- Water Temperature

VHF Radio (Raymarine 220) w/Remote Speaker &

8' Fiberglass Antenna

Electrical Systems:

Batteries, 8-D w/Boxes (2)

Battery Charger/Converter, 120V/50 Amp/12V

Electronics Circuit w/Ground Plate, 50 Amp/12V

Inlet, TV Coax & Telephone w/Cords

Isolators, Galvanic (2)

Panel, DC Main Breaker

Panel, Main Distribution - AC

Panel, Main Distribution - DC

Panel, Remote Circuit Breaker

Shore Power, Cablemaster (Glendinning)

50 Amp/240V/60 Cycle w/75' Cords & Wireless Remote
(Glendinning Cablemaster is not available w/220V/50 Cycle)

Transformers, Shore Power Isolation, 50 Amp/120V/60 Cycle

Wiring, Color-Coded w/Chafe Protection

Generator:

Remote Start w/Muffler, Freshwater Cooling, Fuel Filter,

Seacock & Seawater Strainer, 240V

12.5 kW Westerbeke™ Diesel w/Sound Box

Air Conditioning/Heating:

Zone-Controlled Reverse-Cycle System

(38,000 BTU - 2.5-Ton)

Custom Integral Vent System

Engine Room:

Bilge Pumps, 12V Automatic (3)

Bilge Pumps, 12V Automatic High-Water (1 Bilge, 1 Cabin)

Blowers, 12V Bilge (2)

Engine Drip Sumps

Exhaust, Power Pac/Lift System Mufflers

Fire Suppression System - Automatic w/Manual Pull

Gel-Coated Engine Room, Gray

Insulation, 2" w/Loaded Vinyl Barrier

Ladder, Stainless Steel - Removable

Lighting, 12V

Oil Changer System

Synchronizer, Engines

Fuel System:

Crossover Fuel System

Fuel Filters (3) (Racor®)

(2) 75-100MAX for Engines

(1) 500MA for Generator

Fuel Lines, USCG - Type A-1

Fuel Tanks, Aluminum w/Anti-Siphon Valves &

Electric Sending Units (2)

Water System:

Freshwater Hose & Spigot - Engine Room

Freshwater Washdown Spigot - Cockpit

Freshwater Washdown Spigot - Transom

Pressure Water System w/12V Pump

Shower, Cockpit - Hot & Cold

Water Heater, 240V (20-Gallon)

Water Inlet, Dockside - Stainless Steel

Water Tank (140-Gallon)

Waste Systems:

Head System (VacuFlush®)

Holding Tank Level Indicators - MDP & Head

Holding Tank w/Dockside Pump-Out (60-Gallon)

Underwater Gear:

Bonding System w/Zinc Hull Plate

Propeller Shafts, 2" Stainless Steel (2) - Aquamet 22

Seacoaks on all Underwater Fittings

Seawater Strainers

Shaft Logs, Dripless w/Extra Seal Carrier Kit

Struts - Manganese-Bronze

Trim Tabs, Hydraulic

STANDARD PROPULSION

T-Cummins® QSM-11 Diesel Inboards

(T-519 hp - 387 kW)

Options/Accessories

OPTIONAL PROPULSION

Twin Diesel Inboards:

T-Cummins® QSM-11

(T-616 hp - 459 kW)

T-Caterpillar® 3196TA

(T-640 hp - 477 kW)

OPTIONAL PACKAGES

Generator Option (in lieu of Std.):

220V/50 Cycle (Int'l)

9.4 kW Westerbeke™ Diesel w/Sound Box

Raymarine Electronics Options:

Autopilot - Raypilot ST 7001+

Radar, RL80CRC - 10" Color LCD High Resolution Radar/Chartplotter

w/4 kW Open Array

INDIVIDUAL OPTIONS

Canvas, Aft Deck Screen Enclosure

Canvas, Black (in lieu of Std. Colors)

Canvas, Dash Cover

Gray Water System

Macerator w/Seacock Interlock System

Refrigerator/Icemaker Combo, 120V (in lieu of Cockpit Icemaker)

Seating, Aft Bench w/Fiberglass Storage Base (Removable)

Sun Pad, Forward Deck

Table, Cockpit - Fiberglass

Transformer, Shore Power Isolation Boost - 50 Amp/240V/60 Cycle

Windlass, All-Chain (in lieu of Std. Rope/Chain) (Lofrans Progress II)

CE Option

VR

For a virtual reality tour
of this boat visit
www.searay.com

NOTE: Boats which are ordered with 220V/50 Cycle Electrical Systems will be installed with the appropriate appliances in the corresponding voltage.

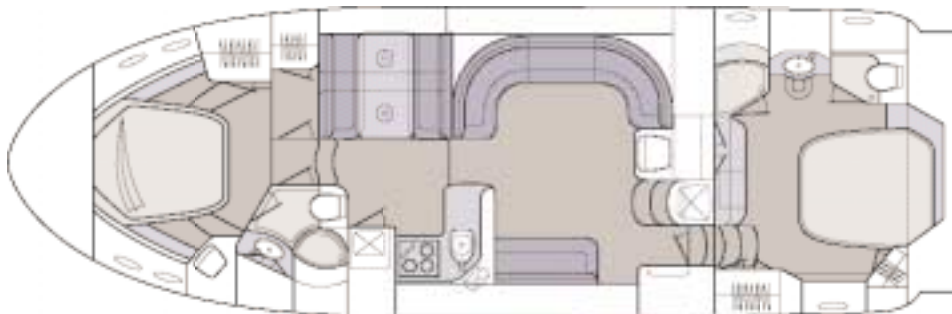

Cabin Layout

480 Motor Yacht

2002



The large aft deck has a wet bar with an icemaker. A Clarion® AM/FM CD with six-disc changer, four speakers and remote control provides a selection of listening entertainment. A fiberglass hardtop protects you from the elements and textured steps lead to the swim platform with concealed stainless steel three-step ladder.



Tug on the ottoman under the starboard sofa, flip it open, and you've got yourself a lovely table that's the perfect place for cocktails and appetizers. Close it up and slide it back under the sofa when you and your guests are ready for dancing.



The aft master stateroom features a queen-size bed, full-length cedar-lined hanging lockers, built-in nightstands and a huge built-in storage unit with storage shelves and drawers, as well as a TV/VCR/radio combo.

Wait a minute. Isn't that you sitting serenely on the afterdeck of that gorgeous Sea Ray 480 Motor Yacht? No? Pity. One quick turn of the key, the quiet, magnificent rumble of twin 535-hp Cummins engines, a stealthy departure (no wake, of course), and you could be on the leeward side of the Caicos before anyone realized you were gone. You could also take along several friends. On the other hand, let them eat conch. Send them a postcard.



A full-size bed with innerspring mattress is the focal point of the forward stateroom. A portside storage cabinet with drawers and starboard full-length hanging lockers with lights and beveled mirrors provide storage. There's also a TV/VCR/radio combo, as well as private access to the main head compartment.



The galley makes wonderful use of space with a custom-molded fiberglass countertop, sink with Grohe® faucet, recessed three-burner stove, microwave/convection oven, coffeemaker and a refrigerator/freezer. A washer/dryer combo is located in the utility room.



The control station is accented by a high-gloss burl panel loaded with custom Sea Ray® backlit instrumentation, as well as illuminated weatherproof rockers and dimmer control. Shift and throttle controls feature gold knobs. The wood-accent wheel with hydraulic steering tilts for easy access to the helm seat. And with the bow thruster, you can absolutely handle any docking situation.

Sea Ray Boats, Inc., 2600 Sea Ray Blvd., Knoxville, TN 37914. For information call 1-800-SRBOATS or fax 1-865-213-7878. Internet address: <http://www.searay.com>

Note: Some equipment shown may be optional. Options and colors shown may not be available. Please see your authorized Sea Ray dealer for color options.

Printed in the U.S.A. July 2001 © Sea Ray Boats, Inc. MRP #1611409